

PRATLEY®

Instruction Leaflet for "PRATLEY STEEL"



CONGRATULATIONS!

The product you have purchased is from a range of the most advanced adhesives and sealants in the world - researched, manufactured and marketed by Pratley.

GENERAL:

Pratley Steel is a *quicksetting* high performance adhesive, metal filler and mender. It is formulated to set hard and match the colour of most ferrous metals. It can be filed, sawn, machined and sanded within 1½ hours of mixing.

PROPERTIES:

- Quick setting.
- Metallic colour and lustre.
- Good adhesive strength.
- Bonds well to most rigid materials.
- Can be filed, sawn, machined and sanded.
- Very hard when set.
- Good shelf life.

TIME TO SET: (at 23° C)

- Will gel in 3 minutes.
- Will be dry to touch in 6 minutes.
- 60% strength in 20 minutes.
- Full strength and completely hard in ± 1½ hours.

SURFACE PREPARATION:

Surfaces to be bonded must be free of loose dirt, rust, paint, oil and grease. Wire brushing or sanding will substantially enhance adhesion to smooth surfaces.

MIXING PROCEDURE:

1. From the tube with the **white cap** squeeze out a bead of resin onto a flat non-absorbent surface such as a piece of cardboard (**Fig. 1**).
2. From the tube with a **black cap** squeeze out an exactly similar bead of hardener next to the first bead (**Fig. 2**).
3. Use only as much as can be applied in 2 or 3 minutes. However, to ensure equal proportions, the beads should not be less than 15 mm long.
4. Replace the colour coded caps on the **correct** tubes.
5. Using a spatula or thin stick, thoroughly and vigorously mix the two beads together until an even colour is obtained (**Fig. 3**).
6. Use within 3 minutes after mixing.

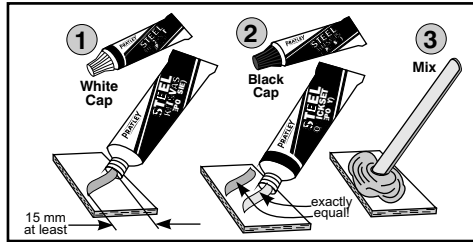

SOME SUGGESTED USES:

1. Filling blow holes in castings.
2. Repairing cracked castings.
3. Bonding metal parts.
4. Making fillets or filling seams in metal parts.
5. Bonding ceramics, slate, tiles, etc., where the colour matches.
6. Repairing silver ornaments.
7. Bonding and repairing most rigid materials including china, stoneware, cement, wood, etc.

NOT RECOMMENDED FOR:

- Bonding rearview mirrors to windscreens.
- Continuous high temperatures (above 80°).
- Flexible materials.
- Prolonged underwater environment.

SOME OTHER PRODUCTS IN THE PRATLEY RANGE:

PRATLEY PUTTY (QUICKSET)

High strength hand moldable putty-like quicksetting adhesive.

PRATLEY PUTTY (STANDARD)

Exceptional strength and easy to use under water. Can be smoothed to a glossy finish.

PRATLEY STEEL PUTTY

Incredibly strong and can be machined like steel.

PRATLEY QUICKSET WHITE AND CLEAR GLUES

For high strength bonding and repairing of rigid materials.

PRATLEY 1-2-3

For quick repairs and bonding when parts are close fitting.

PRATLEY WONDAFIX

A unique (patented) high strength, high toughness flexible repair system.

PRATLEY FLEXISEAL

A permanently flexible caulk type sealer for joints and cracks.

PRATLEY "PRATLOK"

A full range of ultra high quality thread locking adhesives.

PRATLEY EZEEBOND

High performance toughened acrylic adhesive.

PRATLEY SUPERGLUE

The best in its class.

PRATLEY "KRAFTEX" RANGE (FOR DECOUPAGE)

A range comprising: Ultra high gloss coatings, crack effects, antique cracks, sealcoat and varnish.

see: www.kraftex.co.za

Note: Some of the above are available in larger industrial packs.

* As product is used outside our control, we cannot accept liability for any possible failures.

Pratley (Pty) Ltd. P O Box 3055 • Kenmare 1745

Gauteng • South Africa.

Tel: +27 11 955-2190/8

Fax: +27 11 955-3918

www.pratley.com