

# PRATLEY®

## Instruction Leaflet for "PRATLEY "WONDAFIX CAR"



### CONGRATULATIONS

The product you have chosen is from a range of the world's most advanced adhesives - researched, manufactured and marketed by Pratley.

### GENERAL:

This patented product is a world first, developed by Pratley. It is a tough but flexible repair compound for a multitude of problematic car repairs.

### PROPERTIES:

- Very tough and shock resistant.
- Very flexible.
- High adhesive strength.
- Bonds well to most materials.
- Abrasion resistant.
- Resists water splash and most chemicals.
- Black in colour.
- No unpleasant odour.

### TIME TO SET:

- Will begin to gel in 3 minutes.
- Completely dry and 20% strength in 1/2 hour.
- 60% strength in 4 1/2 hours.

### SURFACE PREPARATION:

All surfaces to be bonded should be clean and free from oil and grease. Glossy surfaces should be lightly abraded.

### MIXING INSTRUCTIONS:

**NOTE:** This is a 2:1 mix which is quite runny for first 2 minutes after mixing.

1. Squeeze out a "sausage" of hardener from the small tube onto a flat non-absorbent mixing surface such as a piece of cardboard. (Fig. 1)
2. From the large tube squeeze out 2 exactly similar "sausages" one either side of the first. (Fig. 2)
3. Replace the colour coded tube caps on the correct tubes.

4. Thoroughly and vigorously mix the 3 "sausages" together using a spatula or stick. (Fig. 3)
5. Apply the mixed adhesive to repair within 2 minutes (i.e. before it begins to gel). After initial gel smooth with wet finger if necessary.

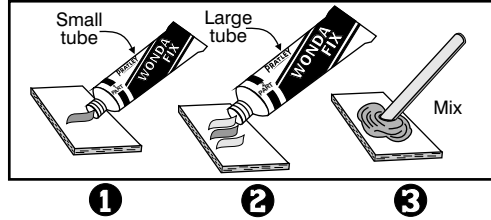

### DASHBOARD REPAIR:

Special procedure for cracked (Black Urethane) dashboard repair as follows:

- Use a Stanley knife to "V" out the crack to about 10mm width.
- Remove all loose particles and dust.
- Allow the **freshly mixed** Wondafix to run off a spatula into the crack. Mix more Wondafix and do this a second time if insufficient.
- Allow the "Wondafix" to form a bead which is "proud" of the dash.
- Wait for about 1 1/2 hours (not longer than 2 1/2 hours or the cut line will be untidy), then use a sharp blade to carefully and steadily remove the Wondafix meniscus and render it flush with the dash.
- Apply a commercial dashboard silicone or motor car black vinyl paint to render the repair almost invisible.

### SOME SUGGESTED USES:

1. Repair scuffed hoses.
2. Repair damaged rubber of car bumper.
3. Repair cracked car dashboard.
4. Repair damaged car air vent pipes and vacuum hoses.
5. Mount or stick articles which tend to vibrate loose.
6. Use as a vibration mounting.
7. For extra strong repairs soak into a bandage and wrap around broken joint.
8. Use to seal and protect wires where they go through the firewall.

9. Cast your own flexible drives or friction drives.
10. Repair vinyl/cloth car seats and side panel trims.
11. Fill cracked windshield rubber seals.
12. Fill any rubber mouldings or flashings on cars.
13. Repair electrical lead insulation.
14. Repair leaks.
15. Use as a gland packing.
16. Repair shoe soles.

### NOT RECOMMENDED FOR:

1. Bonding rearview mirrors to windscreens.
2. High temperature applications (above 105°C).
3. Adhesion to plastic or rubber surfaces which are glossy.
4. Continuous underwater use.
5. Sealing fuel leaks.

### SOME OTHER PRATLEY PRODUCTS:

#### PRATLEY PUTTY (QUICKSET)

High strength hand mouldable putty-like quick setting adhesive.

#### PRATLEY PUTTY (STANDARD)

Exceptional strength and easy to use under water. Can be smoothed to a glossy finish.

#### PRATLEY STEEL PUTTY

Incredibly strong and can be machined like steel.

#### PRATLEY STEEL

For quick set metal mending where colour is important.

#### PRATLEY QUICKSET WHITE AND CLEAR GLUES

For bonding and repairing any rigid materials.

#### PRATLEY WONDAFIX

A unique (patented) high strength, high toughness flexible repair system.

#### PRATLEY FLEXISEAL

A permanently flexible waterproof sealer for joints and cracks.

#### PRATLEY "PRATLOK"

A full range of ultra high quality thread locking adhesives.

#### PRATLEY MIX

General purpose repair kit for concrete, floor patching etc.

#### PRATLEY EZEEBOND

Toughened acrylic adhesive.

#### PRATLEY SUPERGLUE

The best in its class.

**Note:** Some of the above are available in larger industrial packs.

Pratley (Pty) Ltd. P O Box 3055 • KENMARE 1745  
Gauteng • South Africa.

Tel: +27 11 955-2190/8

Fax: +27 11 955-3918

Website: [www.pratley.com](http://www.pratley.com)

6/3/2001  
9288