

# PRATLEY®



## Instruction leaflet for PRATLEY POWDA BOND

### CONGRATULATIONS

The product you have purchased is from a range of the most advanced adhesives and sealants in the world - researched, manufactured and marketed by Pratley.

### GENERAL:

Powda Bond is an instant repair system which can be used either as a two part kit for filling gaps or a single adhesive for bonding.

### Pack contains:

- 1 x Adhesive (Special Grade Super Glue)
- 1 x Grey Filling Powder
- 1 x Black Filling Powder

### PROPERTIES:

- Sets Ultra Fast.
- Can be painted.
- Can be sanded or filed.
- Can be exposed to water once hardened.

### TIME TO SET:

- Surface will begin to harden in approximately 5 seconds after all liquid has been absorbed.
- Adhesive will harden fully after approximately 20 seconds. (Takes longer in cold weather)

### SURFACE PREPARATION:

1. Remove any loose material, like paint from surfaces to be bonded.
2. Roughen the surfaces slightly with sandpaper.
3. Ensure surfaces are clean and dry.

### APPLICATION INSTRUCTIONS:

**SAFETY NOTE:** Work in a well ventilated area as the reaction of the liquid (Powda Bond Adhesive) and the powder (Powda Bond filler) produces an irritating vapour. Also the adhesive has very low viscosity, so use it carefully to avoid it jetting/squirting out! The use of disposable gloves and eye protection is strongly recommended.

**NOTE:** You may need to place some tape underneath any gaps being filled to ensure that the powder (Powda Bond filler) does not fall through the gap. This tape should be removed after the powder has hardened. Sometimes it may be necessary to repair the item from both sides or in layers as penetration of the liquid into the powder is about 10mm.

1. **Fig. 1** - Apply the appropriate colour powder (Powda Bond filler) to the area being repaired.
2. **Fig. 2** - Open the liquid (Powda Bond Adhesive) by removing the 'tear-off' safety collar and pushing down hard on the cap - a pin in the cap will pierce the nozzle.
3. **Fig. 3** - Carefully apply the liquid to the powder (see safety note). Make sure that the applicator nozzle does not touch the powder, or make contact with the "smoke" (vapour) as this will clog the nozzle.  
Note that once the surface has hardened (approximately 5 seconds after all liquid has been applied), no more liquid will be absorbed by the powder.
4. Wipe nozzle tip with a dry tissue and replace cap.
5. Once fully hardened (approximately 20 seconds) Powda Bond may be sanded or filed and painted over.

### WARNING - PROTECT EYES!

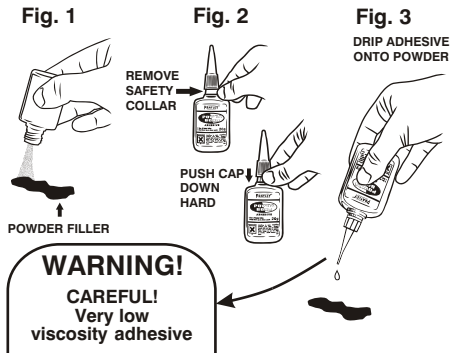

\* As product is used outside our control, we cannot accept liability for any possible failures.

### SOME SUGGESTED REPAIRS:

1. Car bumpers.
2. Damaged wheel caps.
3. Motor cycle fairings.
4. Electrical switches.
5. Damaged Carburetors.
6. Radiators overflow.
7. Pool Pump Valves.

### NOT RECOMMENDED FOR:

- Use on Polyethylene, Polypropylene and PTFE plastic substrates

### USEFUL TIPS/HINTS:

#### • Plastics

Certain plastics (Polyethylene, Polypropylene and Polytetrafluoroethylene-PTFE) do not adhesively bond unless special industrial surface treatments are performed. This is because they have low surface energies. To identify these plastics place a drop of water on the surface. If it forms a high (almost spherical) bead, it is a low surface energy plastic. If it forms a rather flat patch the plastic has a higher surface energy and is more likely to be bonded by an adhesive. Pratley Powda Bond should not be used on flexible parts.:

#### • Layers

Pratley Powda Bond will harden to a depth of about 8-10mm. If thicker sections are needed, you can apply layers one on top of the other.

#### • Temperature

Pratley Powda Bond should not be used in continuous temperatures above 75°C.

#### • Storage

Pratley Powda Bond should be stored in a cool, dry place when not in use.

#### • Adhesive Nozzle

To prevent the nozzle from blocking, it should be kept clean and moisture free, and away from the powder and away from the vapours that come off the powder during curing. Do not handle the nozzle as your hands are moist and moisture will cure the adhesive. Wipe nozzle with a dry tissue before replacing the cap.

**Pratley (Pty) Ltd.** P O Box 3055  
KENNARE 1745 • South-Africa.  
Tel: +27 11 955-2190/8 • Fax: +27 11 955-3918  
**www.pratley.com**

20/10/2009